



Aerator - scarifier

## 1. INTRODUCTION

The rotary aerator is used for the maintenance of lawns. It gently disturbs its surface and thereby opens the way for the air, water and fertilizer to enter all the way through to the grassroots. In this manner it helps to secure the healthy growth of lawns.

## 2. Technical description

The rotary roller is to be mounted onto the sweeping device. After the disassembly of the brushes the aerating rollers are attached using the connecting rod M12 in the direction of the riding and the rotation of the rollers in such a way, so that the springs would be loose. The adjustment consoles are to be mounted with the travel wheels instead of the support wheels and the front protective cover is attached.

## 3. Technical information

Catch width	900 mm
Amount of rollers (left + right)	1 + 1
Diameter of rollers	300 mm
Revolutions of rollers	98 rev.
Amount of springs in 1 roller	44 pc
Weight of 1 roller	7 kg

## 4. Technical description of groups

The rotary roller is made from steel. To the sheet-metal flange with a hexagonal catch driver there are welded four connecting rods, onto which are placed the steel springs. The rods are connected by the second flange with the adjustment consoles and the traveling wheel. The springs make grooves in the lawn which are 30-50 mm deep and separated from each other by 40 mm.

## 5. Operating instructions

Mount the aerating rollers and the front cover onto the frame of the sweeping device. Set the control lever for swiveling to the straight direction. It is not allowed to swivel the machine to the left or the right side. The travel wheel with the adjustment consoles is to be inserted onto the bearing, which is bolted onto the aerating roller.

We recommend to perform the aerating works on a cut and damp lawn.

**DRIVE ONLY IN A STRAIGHT DIRECTION!!!**

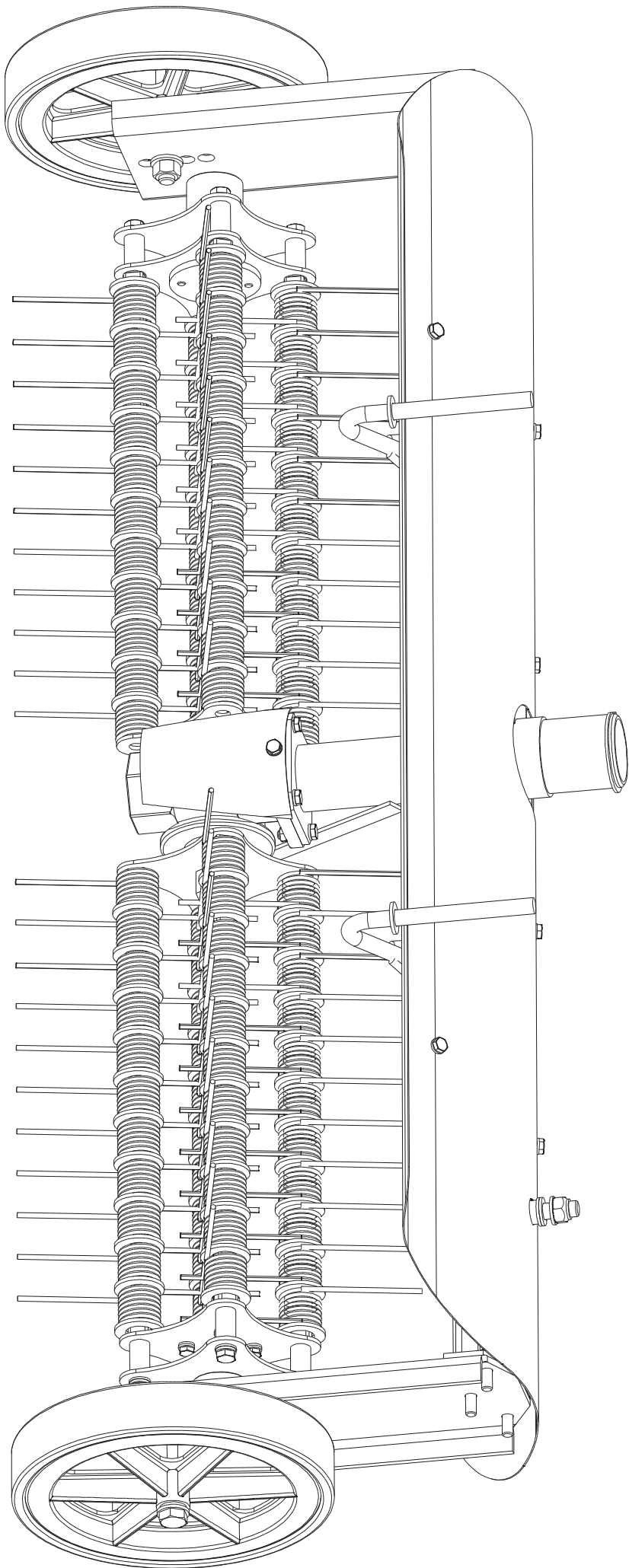

Kusovník			
POZICE	KS	ČÍSLO SOUČÁSTI	POPIS
1	1	100-000	
2	1	119-000	
3	1	119-001	
4	1	100-000 PRAVÝ	
5	2	75151 - KOLO RAPID (AERATOR)	
6	9	DIN 125 - A 13	Podlo ka
7	5	ISO 4032 - M12	estihovaná matice
8	2	DIN 933 - M12 x 100	estihovaný roub
9	1	DIN 127 - A 12	Pru ná podlo ka
10	1	2005-000 SPOJOVACÍ TYČ 920 (AERATOR)	

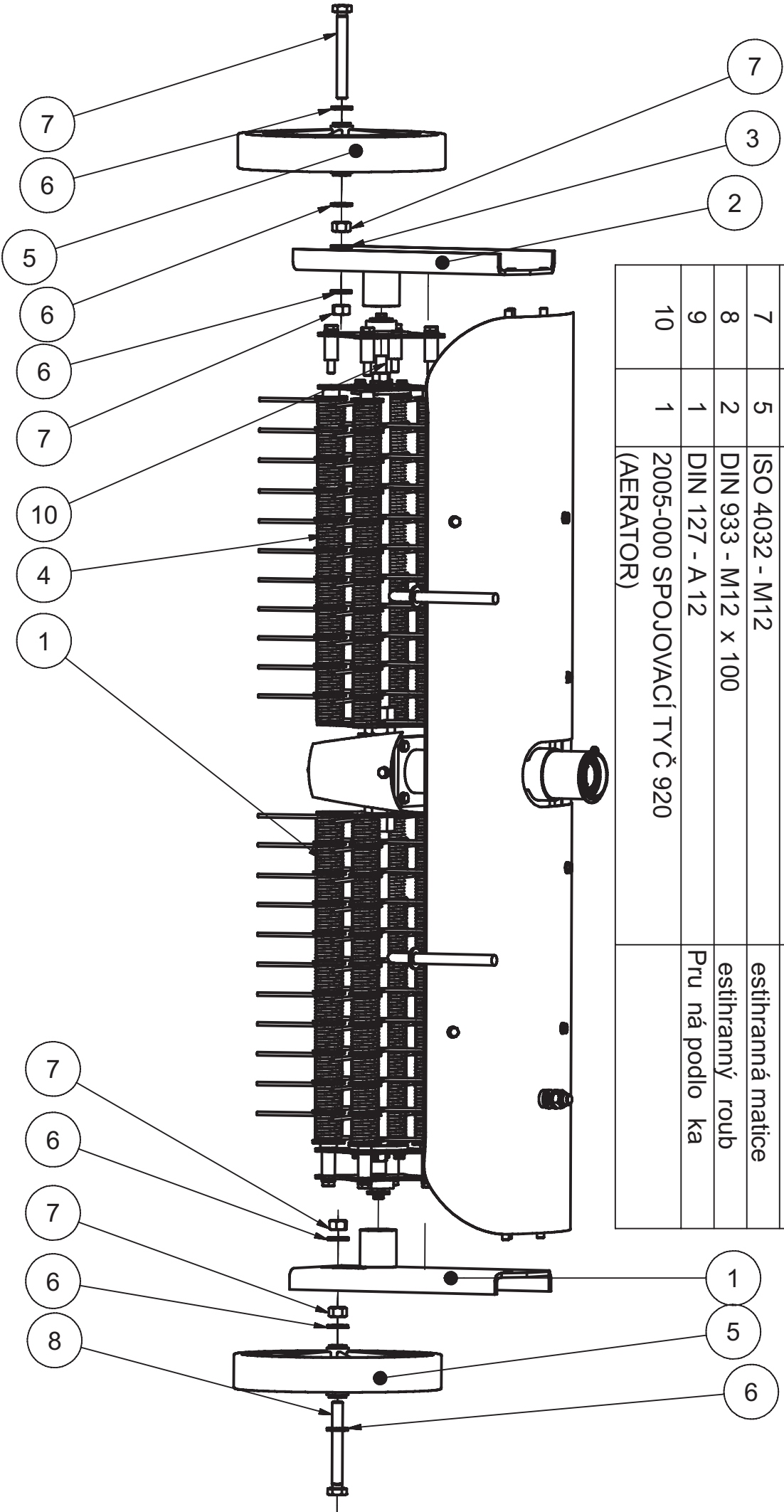

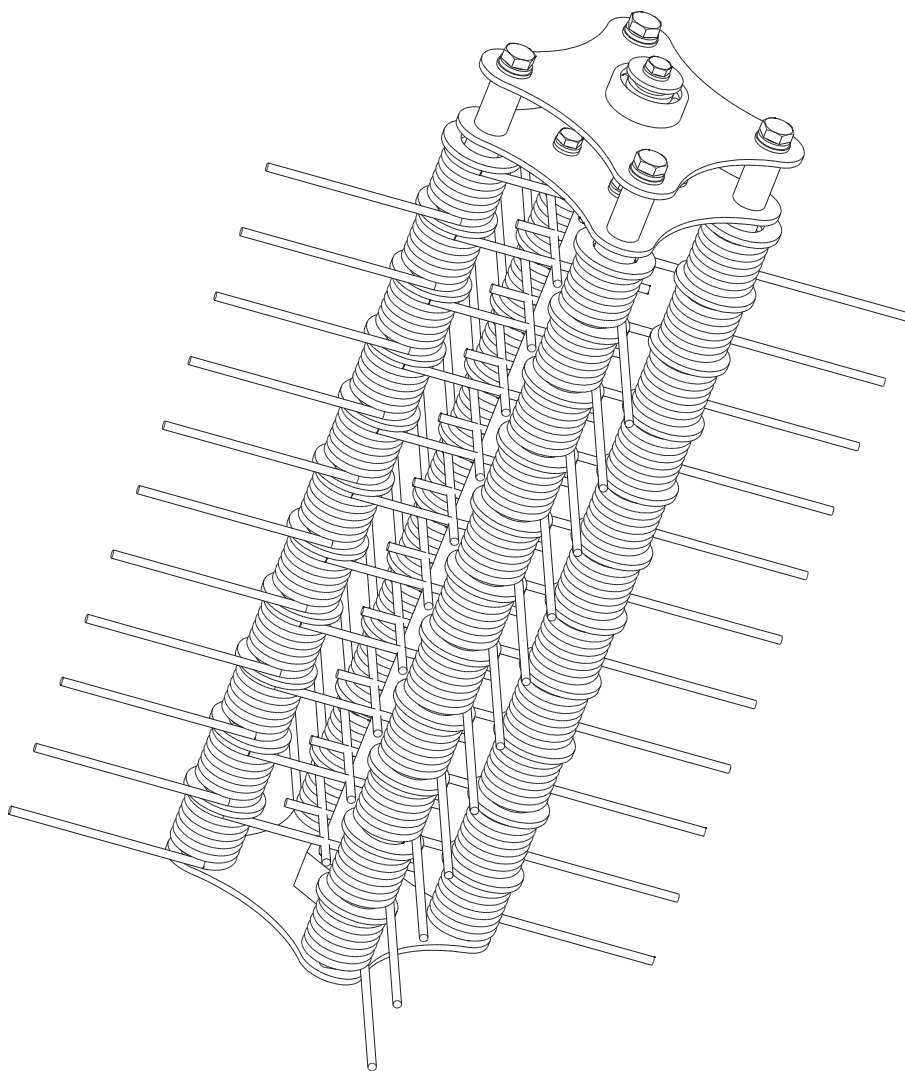
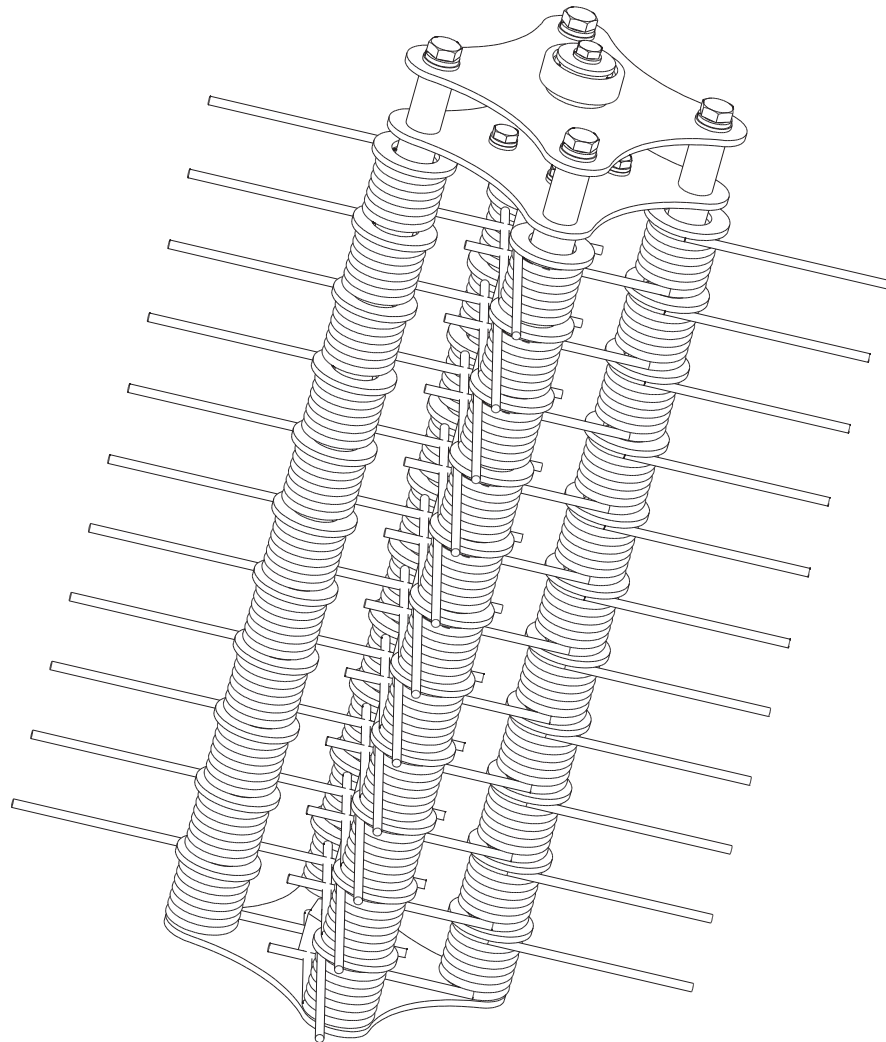

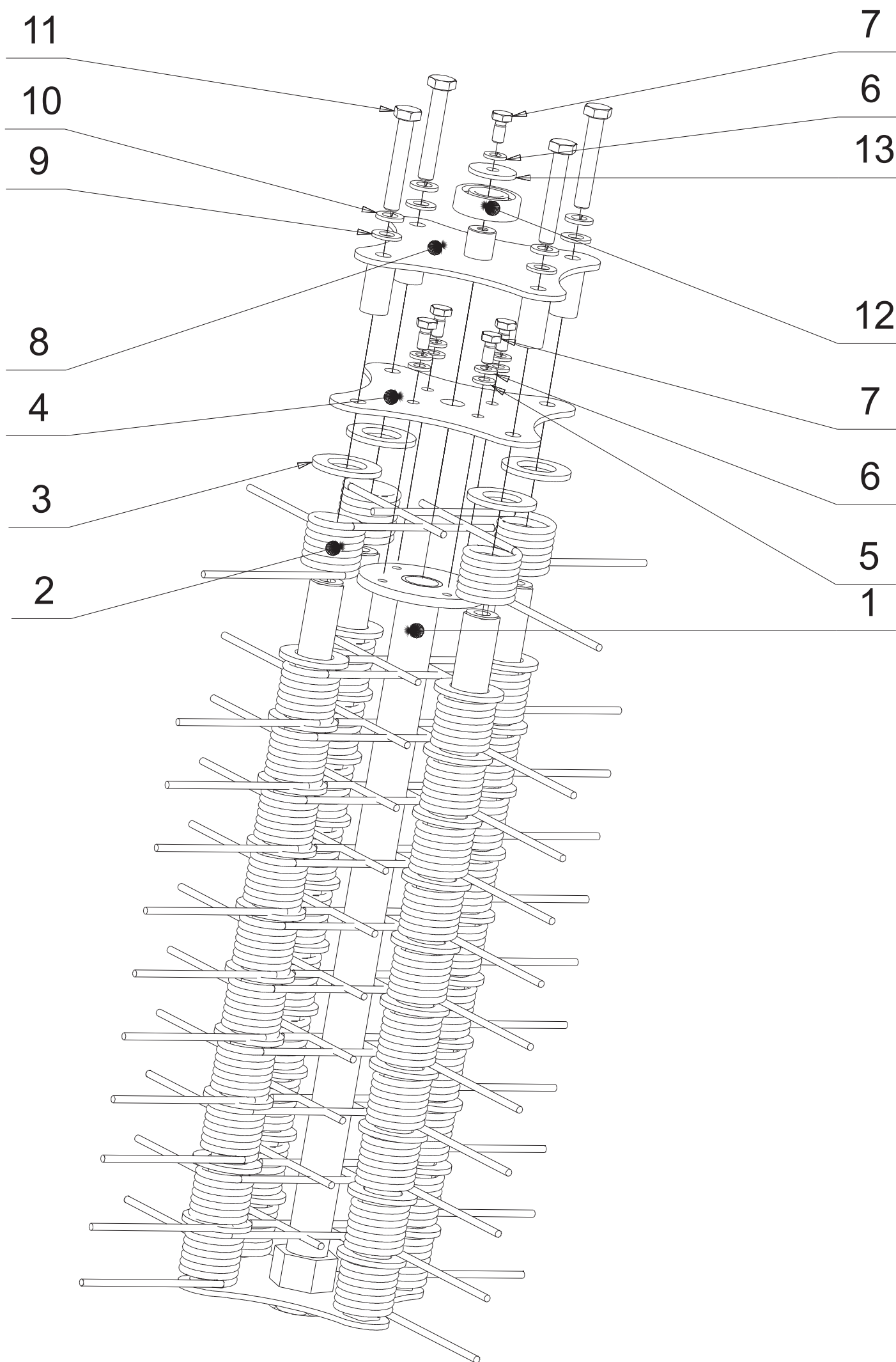

1	1	100-009	
2	44	PRUŽINA	
3	44	DIN 125 - 21	Podložka plochá
4	1	100-010	Výpalek
5	4	DIN 125 - 6,4	Podložka plochá
6	5	M - 6	Podložka pružná
7	5	M6 x 12	estihanný roub
8	1	100-011	
9	4	DIN 125 - 8,4	Podložka plochá
10	4	M - 8	Podložka pružná
11	4	M8 x 50 s tělem	estihanný roub
12	1	SKF 6202	Kuličkové ložisko
13	1	Velkoplošná silná M6	Plochá podložka